

IEC appliance inlet C14, screw-on mounting, front side, quick connect/screw terminals



Screw-On Version

C14  
  
 70 °C



### Description

- Panel Mount:  
Screw-on from front side
- Inlet, Pin temperature 70 °C, Protection class I
- Screw

### Approvals

- VDE License Number: 77564
- UL License Number: E96454

### Weblinks

[Approvals](#), [RoHS](#), [CHINA-RoHS](#), [e-Store](#), [SCHURTER-Stock-Check](#), [Distributor-Stock-Check](#)

### Technical Data

Ratings IEC	10A / 250VAC; 50Hz	Appliance-Inlet/-Outlet	C14 acc. to IEC/EN 60320-1, UL 498, CSA C22.2 no. 42 (for cold conditions) pin-temperature 70 °C, 10A, Protection class I
Ratings UL/CSA	10A / 250VAC; 60Hz		
Dielectric Strength	> 2 kVAC between L-N > 2 kVAC between L/N-PE (1 min/50Hz)		
Allowable Operation Temp.	-25 °C to 70 °C		
Degree of Protection	from front side IP 40 acc. to IEC 60529		
Protection Class	Suitable for appliances with protection class I acc. to IEC 61140		
Terminal	Screw		
Panel Thickness s	Screw-on: max 8 mm Mounting screw torque max 0.5 Nm		
Material: Housing	Thermoset, black, UL 94V-0		

### Dimensions

8843.FL

Length |—————| 48 mm

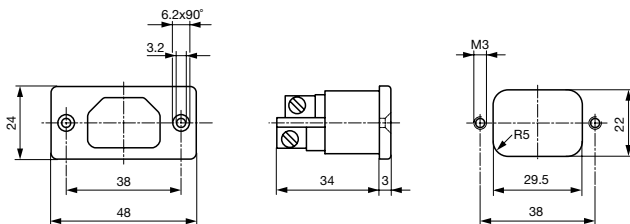

Screw M3

### Variants

[Distributor-Stock-Check](#) | [SCHURTER-Stock-Check](#) | [e-Store](#)

Type	Order Number
8843.FL	4300.0065

**Packaging unit** 50 Pcs

## Accessory

### Description



Assorted Covers  
Rear Cover

0859.0086